



LA TROBE
UNIVERSITY
AUSTRALIA

International Course Guide

20
23



Contents

Choose a university where you can thrive

Study your way	2
Living in Melbourne and Victoria	4
Our campus network	6
Living at La Trobe	10
Staying safe and healthy	12
Fees and scholarships	13
Student support	14
Prepare for your career	16
Academic and English language requirements	18
International student pathways	19

Find the right course for you

Undergraduate courses	20
Postgraduate courses	24
Research at La Trobe	28
Graduate research school	30
How to apply	32
Key terms	33



Sianlee Harris, Artist.
Ngurta-ahna Kiiraka (Place of Knowledge and Learning), 2020.
© Courtesy of the artist. Photo: Ian Hill.

La Trobe University acknowledges our campuses are located on the lands of many Traditional Custodians in Victoria and New South Wales. We recognise their ongoing connection to the land and value their unique contribution to the University and wider Australian society.

La Trobe University is committed to providing opportunities for Aboriginal and Torres Strait Islander people, both as individuals and communities, through teaching and learning, and research and community partnerships across all our campuses.

Why choose La Trobe?

For over 50 years, La Trobe University has been transforming people and societies.

Striving for excellence in everything we do, we've risen to the top one per cent of universities worldwide¹ as we address the major issues of our time – with all our broad areas of research rated 'at', 'above' or 'well above world standard'.² In the latest QS World University Rankings, we moved up by 46 places – the strongest improver in Australia.³

Whether it's helping solve issues with global food insecurity, protecting the world's biodiversity, understanding and preventing disease, or leading social change and equity, La Trobe University is at the forefront of impactful research – especially in science, health and technology. That's why we're rated fourth internationally for our research on key diseases and conditions, support for healthcare professions and the health of our students and staff.⁴

At La Trobe, we embrace the power of equality, diversity and inclusivity. We exist for the good we can do and the impact we make for our students and communities, both locally and around the world. The student experience is placed at the centre of everything we do. That means providing a leading academic experience, ensuring your safety and wellbeing, and connecting you to our communities and your future industries.

Our focus on social impact and inclusivity is why we are in the top 20 universities globally for our overall contribution to advancing the United Nations' Sustainable Development Goals.⁵ This includes being in the top 10 universities worldwide for gender equality.⁶

We are problem-solvers by nature and inherently optimistic – continuously improving the way we work and adapting quickly to disruption. That's why at La Trobe, we'll help you develop every part of your skillset, including the human skills you'll need in any workplace – like leadership, collaboration, critical thinking, creativity and adaptability.

We're committed to ensuring our students, researchers and partners remain at the forefront of innovation and technology. Across our campuses, we continue to invest in state-of-the-art facilities. Our AU\$50 million upgrade of the Bendigo Campus was recently completed. In Melbourne's north, we're creating a AU\$5 billion University City of the Future and we're also investing AU\$10.5 million to redevelop our Shepparton Campus.

At La Trobe University you'll be surrounded by academics, researchers and industry professionals who make a real impact every day, so you can, too.



5 star rating
for teaching,
employability, research,
online learning, arts
and culture and more⁷



Top 20
worldwide
for impact⁵



The strongest
improver in Australia
for work to advance the UN's
Sustainable Development Goals³



Top 10
worldwide
for gender
equality⁵

1. Times Higher Education (THE), 2021, World University Rankings 2022; Consejo Superior de Investigaciones Científicas (CSIC), 2021, Ranking Web of Universities.
2. Australian Research Council, 2019, Excellence in Research for Australia (ERA) Outcomes 2018.
3. QS World University Rankings, 2023.
4. Times Higher Education (THE), 2022, Impact Rankings 2022: good health and well-being.
5. Times Higher Education (THE), 2022, Impact Rankings 2022: gender equality.
6. Times Higher Education (THE), 2022, Impact Rankings 2022: gender equality.
7. QS Stars Rating 2021.

Study your way

Whether you're not completely sure of the career path you want to take, or if you're ready to explore a niche area, at La Trobe you can tailor your degree to fit your interests, broaden your career options further and gain specialist skills future employers are looking for.

With more than 50 majors, minors and deeper specialisations now available, you can even include subjects outside your course.¹ You can also use your industry experience towards your course credits to help fast-track your career.



Expand your career options

More majors, minors and subjects

Build the career you want with over 50 majors, minors and electives to choose from. For example, you could add our climate change minor to your degree and become your future organisation's environmental leader.

Study in areas that go beyond your degree

Combine your degree with a major or minor from another discipline to gain the important cross-skills that are highly sought after. Studying health sciences? Consider adding a management major to boost your employability.

More pathways towards a full degree

Do you need help to meet the academic entry requirements for your preferred undergraduate course? La Trobe College Australia (LTCA) offers foundation studies and Diploma programs to prepare you for undergraduate study.



Boost your employability

Do an industry placement minor

You can gain credits for industry experience by choosing an industry placement minor for your degree. That means you can focus on your chosen industry and build your professional networks before you graduate.

Learn from our industry partners

We partner with the best so you can be your best. In courses co-designed and taught with industry, you'll gain skills and knowledge from professionals in their field.

Build experience while you study

You don't need to do an industry placement minor to gain valuable work experience that counts as credits toward your chosen degree. Work integrated learning (WIL) is available across many of our degrees.



Stand out from the crowd



86.5%

of our undergraduates found employment within **four months** of graduating²



More than

230,000

alumni spanning over **100 countries**



La Trobe graduates are **reputable**, with employers giving them an overall rating³ of

87.8%

1. Not available for all courses.

2. Quality Indicators for Learning and Teaching (QILT), 2021. *ComparED: Overall undergraduate results for La Trobe University.*

3. Quality Indicators for Learning and Teaching (QILT), 2022. *2021 Employer Satisfaction Survey.*

Living in Melbourne and Victoria

La Trobe University is proudly located in Australia's most liveable city.¹

Victoria's capital city, Melbourne, is rated the #1 city in Australia and #5 in the world for international students.² That means when you study in Melbourne, you're in the best city in the world for stability, healthcare, culture, environment, education and infrastructure.

Move around easily

Moving around Melbourne and wider Victoria is easy, with a range of transport options to fit your lifestyle.

Public transport

In Melbourne, there are extensive train, bus and tram networks. You can travel inside the city, or out in regional Victoria using a Myki card. Our Melbourne Campus in Bundoora has a bus station on campus, plus a tram line right out the front, so you can get where you need to go. Visit Public Transport Victoria (PTV) for more information: ptv.vic.gov.au

Ridesharing services

If you like convenience, you'll love the reliable and safe rideshare services available in Melbourne and regional Victoria. You can access these services via a mobile phone app from **Uber**, **Ola** and **DiDi**.

Car sharing services

If you prefer to drive yourself but don't need a car every day, car sharing services can help you get where you need to go. In metropolitan Melbourne you can hire a car, van or truck via a mobile app from **KINTO**, **GoGet**, **FlexiCar** and **Popcar**.

Join a multicultural and inclusive community

Melbourne is one of the safest and most diverse cities in the world to live, study and work. It's home to people from more than 200 countries, with almost fifty per cent of people living in Victoria either born overseas or with at least one parent who was born overseas.³

You'll feel right at home with the vast choice of food options, community groups to join, and multicultural and multifaith events happening all year.

Living in Victoria means you'll meet people from diverse cultures and allow you to grow your understanding of new communities.

Immerse yourself in arts and culture

Both metropolitan and regional Victoria have prominent arts and culture scenes – there's always something interesting to do and see. Most major galleries and museums are also free to enter.

Some places to explore while in Victoria include:

- National Gallery of Victoria (NGV)
- The Australian Centre for the Moving Image (ACMI)
- Melbourne Museum
- Heide Museum of Modern Art
- Bendigo Art Gallery
- Shepparton Art Museum

Or if you prefer exploring Australian nature and wildlife, there are a range of gardens and national parks near our campuses.

You'll get the best of both worlds at La Trobe. Live in Melbourne and enjoy an urban lifestyle while surrounded by Australian wildlife and landscape at La Trobe's very own Nangak Tamboree Wildlife Sanctuary at our Melbourne Campus – the only on-campus wildlife sanctuary in Australia.

Love sport? Whether you like to watch or play, there's always something sporty going on in Melbourne, the home of Australian football (AFL) and the Melbourne Cricket Ground (MCG).

You can stay fit and explore more about sport at our state-of-the-art Sports Park located at our Melbourne Campus.

Living costs

Other than your course fees, there are some additional costs that you'll need to consider when thinking about moving to Victoria.

Rent	AU\$230 to AU\$530 per week
Groceries and eating out	AU\$159 to AU\$365 per week
Phone and internet	AU\$28 to AU\$53 per week
Public transport	AU\$23 to AU\$46 per week
Entertainment	AU\$30 to AU\$130 per week
Gas, electricity and water	AU\$30 to AU\$75 per week

While your exact costs will vary depending on your budget and lifestyle, we've prepared an indicative guide to costs of living in Australia: latrobe.edu.au/int-living-costs

Your costs will also vary based on where you study. For example, living on or near our regional campuses is cheaper than living near our metropolitan campuses.

Our website has more information about accommodation costs around our campuses: latrobe.edu.au/int-accomm-costs

Student visa costs

If you're studying on campus, you'll need to get and maintain a valid passport and student visa to study in Australia. If you accept a full-time study offer from us, you can use the Confirmation of Enrolment (CoE) letter we provide you to apply for a student visa. As you go through this process, you'll need to cover application costs.

During the application process, you also need to prove to the Department of Home Affairs (DoHA) that you have enough money to pay for at least 12 months of your course fees and living costs. The DoHA estimates that 12-month living costs are AU\$21 041 for students or guardians, plus an additional AU\$7 362 for a spouse or partner coming with you, and an additional AU\$3 152 per child coming with you.

For the latest information about Australian student visas and associated costs, visit the DoHA website:

immi.homeaffairs.gov.au/visas/getting-a-visa/visa-listing/student-500

Overseas Student Health Cover (OSHC)

If you come to Australia on a student visa, you need to pay for an OSHC policy. This covers you and any dependents, and helps you stay healthy and happy while you study with us. We have partnered with Medibank Private to help offer you affordable and comprehensive OSHC.

Learn more at latrobe.edu.au/int-oshc

1. Economist Intelligence (EIU), 2022, The Global Livability Index 2022
 2. QS Best Student Cities Rankings 2023
 3. Live in Melbourne, 2021, Multicultural Communities

Our campus network

With a focus on innovation and an eye on the future, we're investing in our campuses every year to support our growing, welcoming communities.

As Victoria's only state-wide university, we have close connections to the communities around our campuses in Melbourne, and across regional Victoria and NSW.

At each of our campuses, you'll find specialist learning and research facilities featuring the latest technologies in industries including health, engineering, science and information technology.

What does that mean for you?



Opportunities for work placements through local and global industry partnerships



Access to unique experiences within a close-knit community



Deeper connections with teachers and students



More cultural, sporting and academic opportunities



Real experience at the centre of world-class, innovative research



Regional study incentives and support

The Australian Government provides additional incentives for international students who study and live in regional Australia, including Destination Australia scholarships worth up to AU\$15 000 and an extension of your post-study work rights.

See latrobe.edu.au/international/fees/scholarships for more information about scholarships, and find out more about post-study work rights at immi.homeaffairs.gov.au/visas/working-in-australia/regional-migration

Stay up to date about campus life

Follow us on social to get latest updates on events, social life and everything else La Trobe.



Facebook
La Trobe University



Twitter
@latrobe



LinkedIn
La Trobe University



Instagram
@latrobeuni

Campuses

Melbourne Campus

Located in the heart of Melbourne's growing north, our campus offers a unique setting for learning, research and employment.

Featuring a state-recognised Research and Innovation Precinct, extensive sports facilities and even its own major wildlife sanctuary, the Melbourne Campus also has vibrant culture with cafes, shops and many social events throughout the year.

Constructing a University City of the Future

The AU\$5 billion investment is redeveloping the campus into a place to live, learn, work, socialise and stay healthy. Our state-of-the-art Sports Park is the new home to the Australian women's national soccer team, The Matildas. Our biodiverse waterway corridor – Nangak Tamboree – is linking La Trobe to the wider community and environment. Our new Digital and Bio Innovation Hubs will help businesses grow by boosting access to our world-leading research.

Learn more at latrobe.edu.au/int-melbourne



Donald Whitehead building
Melbourne



Brian Grogan building
Mildura

Mildura Campus

Be a part of a strong arts and agricultural community situated on the Murray River.

Studying at La Trobe's Mildura Campus offers you the best of both worlds – a leading university and a welcoming and supportive campus.

We've got close ties to the local community through industry partnerships and placement opportunities, which means you'll get a practical learning experience with promising employment outcomes.

Shaping healthy living with world-class research

We're exploring how social, community, genetic and environmental factors influence the health outcomes of people with chronic disease.

Learn more at latrobe.edu.au/int-mildura

Bendigo Campus

Enjoy the best of the city and country at La Trobe's second-largest campus, less than two hours from Melbourne.

With a vibrant campus community, you'll connect with friendly, like-minded people and be supported every step of the way. Benefit from exciting opportunities with community partners as you prepare for your career. We have a diverse range of partners providing our students with strong links to industry including sport, business, the arts and health.

Transforming our campus with a AU\$50 million upgrade

We're in the process of a AU\$50 million Transformation Program at our Bendigo Campus. This upgrade includes a new science and engineering building, bus interchange to make arriving on campus easier, an extension to the library, and new facilities at the sports field.

Learn more at latrobe.edu.au/int-bendigo



Engineering and Technology building
Bendigo

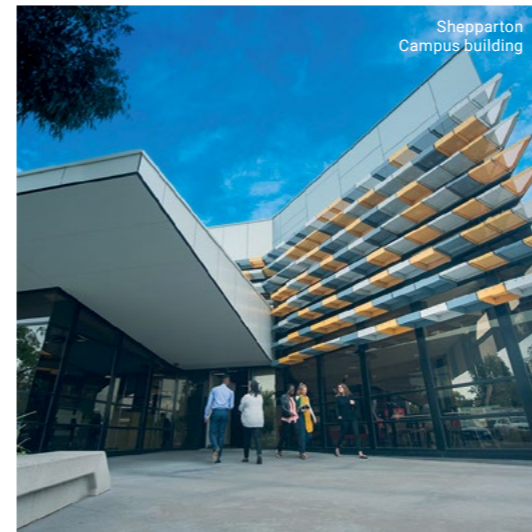

Shepparton
Campus building

Shepparton Campus

In the heart of Shepparton, our campus has great facilities, dedicated staff and strong connections to our diverse, multicultural community.

Enjoy a vibrant and supportive campus culture and access to industry placement opportunities with local partners that will equip you with job-ready skills before you graduate.

Announcing a AU\$10.5 million campus redevelopment

The future-proof design will include high-tech clinical teaching spaces, an expanded library, modern study areas and a flexible space for community and cultural events.

Learn more at latrobe.edu.au/int-shepparton

Albury-Wodonga Campus

Become part of a welcoming community, while enjoying the backdrop of the Murray River.

Enjoy a personalised learning experience with friendly staff, modern facilities and placements with industry partners. Surrounded by snowfields, historic towns, cultural and sporting events, Albury-Wodonga also has promising employment opportunities.

Researching what matters for the local community

Our campus is home to two significant and highly productive research centres, where we focus on issues impacting our community, such as water management and ageing.

Learn more at latrobe.edu.au/int-aw

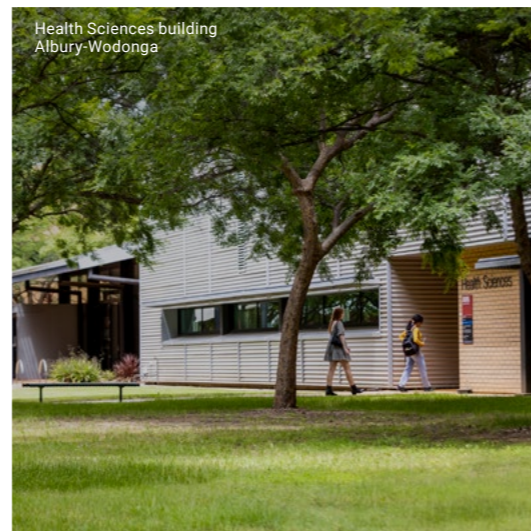

Health Sciences building
Albury-Wodonga



Lecture theatre
Sydney

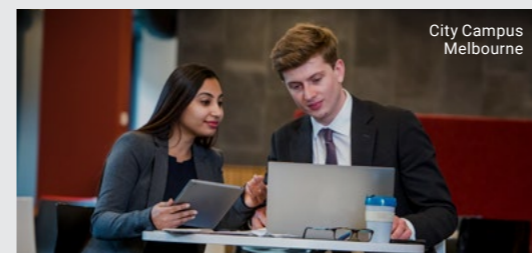

City Campus
Melbourne

Sydney Campus

Our AU\$10 million Sydney Campus is close to work and internship opportunities, located in the heart of the Sydney CBD.

From foundation studies to full degrees, our Sydney Campus is a vibrant environment to build your skills and knowledge.

Learn more at latrobe.edu.au/sydney

City Campus

Our City Campus is in the centre of Melbourne's business district and offers a range of postgraduate degrees.

You can choose to move your career forward with a postgraduate course in business, health or law. Benefit from access to career and study support in our modern facilities surrounded by our multicultural city.

Learn more at latrobe.edu.au/int-city

Living at La Trobe

Student accommodation

We're excited to welcome students from all over the world back on campus.

Before you arrive in Australia, we're here to help you find somewhere to live that suits your lifestyle, is convenient for travel and study, and matches your budget. We offer on-campus accommodation at our Melbourne, Bendigo and Albury-Wodonga campuses. For many international students, it's the ideal choice. Here's why.

Join a diverse and welcoming community

As soon as you arrive, you'll feel at home. There's a diverse community of friendly students ready to meet you. From day one, there are orientation events and cultural activities for you to explore. It's a great way to make friends and be part of campus life.

Our residential colleges have common spaces where you can chat with friends, watch a movie or even challenge someone to a game of table tennis. We also have social activities throughout the year. Think wildlife tours, yoga, cooking classes, rock climbing and more.

Excellent entertainment, services and facilities

Take the worry out of setting up home in Australia by moving into fully furnished accommodation. It's set up with everything you need: gas, electricity, internet and all the other essential services. All your utilities, including laundry, are included in your weekly rent price when you live on campus.

You'll also have access to study areas, computer labs, gyms, gaming rooms, home cinemas, chill-out areas and every on-campus event you can imagine. There are food truck days, cultural events, public lectures and so much more. Most of it's free, so you'll have fun and save money at the same time.

Affordable accommodation options for your lifestyle

Whether you're looking for a quiet place to study or a vibrant, social atmosphere, we've got accommodation options to suit you at our Melbourne, Bendigo and Albury-Wodonga campuses.

For a social vibe, you might choose a residential college. Or maybe a self-contained unit is more your style.

Great support

We're here to help settle you into campus life and guide you through any challenges. Need help with your studies? We've got you covered with free academic mentoring. We also care about your health and wellbeing, so there's 24-hour accommodation staff on-site to help, as well as a 24-hour student support hotline, one-on-one counselling and self-help resources.

Safe, secure and convenient

Campus accommodation is safe and secure. You'll have peace of mind, with security buses and security escorts available if you're ever travelling late at night or walking by yourself on campus after dark.

Did we mention convenient? There's no need to worry about sleeping through your alarm again, with classes only minutes away. Not to mention the money you'll save on transport. You're also perfectly placed to make the most of the amazing events and facilities on campus.

Want to find out more?
Visit latrobe.edu.au/int-accommodation

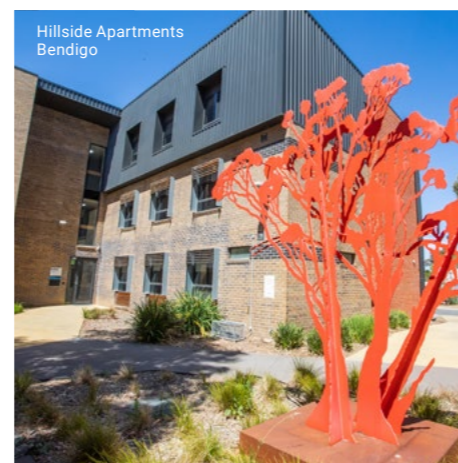

Off-campus accommodation

If you want to study at one of our other campuses, or just want to see what alternative accommodation options are out there, there's off campus options which are affordable and convenient. It's just about finding the right fit for you.

Explore your options at latrobe.edu.au/accommodation

When you're preparing to rent, it's helpful to consider your living costs and budget. Your preferred accommodation location, lifestyle needs and choices will affect your costs. You can discover more about living expenses at latrobe.edu.au/study/life/living/costs

Staying safe and healthy

We want to help you stay safe, healthy and happy while you're studying at La Trobe.



Moving to a foreign country can be daunting, but don't worry – we have a range of services and initiatives put in place to help you stay safe, healthy and happy while you're studying at La Trobe.

On-campus safety

La Trobe's campuses are a safe, welcoming and inclusive environment, and our security team are available across all campuses 24 hours a day, 7 days a week, to keep it that way. Whether you need help navigating campus after-hours, or have a minor accident and require first aid, our friendly security team is always nearby ready to help. If you ever need security's help, you can call them from any campus on **(03) 9479 2222**. If your emergency is urgent and requires Police, Fire or Ambulance, call **Triple Zero (000)** first.

Counselling and mental health

University life can be fun and rewarding, but at times can also be tough. With pressures, demands and life experiences sometimes impacting our studies and everyday life. La Trobe has a diverse team of professional counsellors that can help provide you with confidential short term individual counselling. It's completely free and available to all students. We also offer specialist counselling services in LGBTIQ+ and men's health.

For more information visit latrobe.edu.au/students/support/wellbeing

Multifaith services

Each person's faith journey is unique and La Trobe embraces and respects people of all religious and spiritual beliefs. We have a range of multifaith services available to help you stay connected and feel supported, including worship/prayer rooms, multifaith spiritual advisors and other faith and spirituality wellbeing resources.

Find out more at latrobe.edu.au/students/support/wellbeing/services/multifaith

Being COVIDSafe

All students and staff have a responsibility to keep our La Trobe campuses COVIDSafe. Compliance with the **Government Health Directions** and the **University's COVIDSafe plan** is an important part of creating a safe environment for everyone. By taking simple precautions, like staying home if you feel unwell, practicing good hygiene and informing the university if you're COVID-positive, we can keep each other safe.

For more information about what we're doing to keep you safe visit latrobe.edu.au/about/novel-coronavirus

Health insurance

If you come to Australia on a student visa, it's essential to have the correct level of health insurance. This will ensure you have access to appropriate help if something goes wrong. The minimum level of health insurance for international students studying in Australia is known as Overseas Student Health Cover (OSHC). If you're on a visa other than a student visa, you aren't eligible for OSHC and need to arrange your own health insurance.

For more information visit latrobe.edu.au/international/prepare/visa/insurance

Fees and scholarships

Studying overseas can offer you a range of exciting opportunities.

But it's important you're prepared for the costs involved. You'll need to manage tuition fees and costs of living, as well as other potential expenses associated with overseas study. Here's the good news: we offer a wide range of scholarships that can help you out.

Scholarships

International study is a big decision, especially when the future can look a little uncertain. So we've designed our range of scholarships to give you the support you need in a changing world. Our generous scholarships mean you could access financial support to study with us. From tuition fee reductions to cash grants, these scholarships recognise your achievements and reward your commitment to your future. We've increased the range and amount of scholarships we offer, so whether you're interested in undergraduate and postgraduate coursework or postgraduate research, there's a La Trobe scholarship for you.

La Trobe International scholarships

La Trobe International Scholarships reward your academic excellence by offering up to a 25 per cent reduction on tuition fees for the normal duration of your course.

To find out whether you could be eligible, visit latrobe.edu.au/int-scholarships

Destination Australia scholarships

This Australian Government initiative supports new international students to study in regional Australia and are worth up to AU\$15 000 per year.

To find out whether you could be eligible, visit latrobe.edu.au/scholarships/destination-australia-scholarships-international-students

Regional Scholarship

If you study at one of our regional campuses, you could be eligible for a one-off payment of AU\$5 000, which will be deducted from your first-semester tuition fees.

To find out whether you could be eligible, visit latrobe.edu.au/scholarships/regional-scholarship-international-students

Regional Victoria Experience Bursary

This is a top-up bursary for a prospective international student who is willing to undertake an undergraduate or postgraduate coursework degree in our Regional campuses.

To find out whether you could be eligible, visit latrobe.edu.au/scholarships/regional-victoria-experience-bursary

Postgraduate research scholarships

We offer a range of postgraduate research scholarships. Find out more about applying for a research degree and the scholarships available to you at latrobe.edu.au/study/apply/international/research

ELICOS Scholarship

International students undertaking an English for Further Studies (ELICOS) course with La Trobe College Australia (LTCA) followed by an undergraduate or postgraduate degree at La Trobe University.

To find out more visit latrobe.edu.au/scholarships/elicos-scholarship

You can find our full range of scholarships at latrobe.edu.au/int-scholarships

Sponsorships

As well as our scholarships, some international students can be sponsored by overseas governments, organisations or companies. Find out more at latrobe.edu.au/int-sponsorships

Study costs

Tuition fees

Tuition fees are the primary cost of studying one of our courses. They're different for every course and are based on your study load – typically 60 credit points per semester, totalling 120 credit points per year for a full-time load. You can find indicative annual fees in this guide. These are based on an annual study load of 120 credit points, except where we indicate they're based on a different study load. You can estimate a total cost for your course based on these indicative fees but remember – fees can change year by year. If we do change the fees for a course, the change takes effect on 1 January the next year.

Find out more at latrobe.edu.au/int-tuition

Other course costs

You may also need to pay other course costs, such as field trips or buying equipment. If a course requires you to pay additional costs, it will be outlined in the 'Fees and scholarships' section on our course pages at latrobe.edu.au/int-courses

Student support

We're there for you every step of the way with advice, information and support.



Our International Student Support team will help you feel at home at La Trobe – whether you're in Australia or studying online – and support you to succeed in your studies.

Choosing a course

If you have any questions about choosing a course or the application process, contact our team. You can find our contact details on the back cover and on our website: latrobe.edu.au/int-contact

Studying in Australia

Pre-departure

Our Welcome to La Trobe website has all the information you need to prepare for your arrival to Australia. The website has up-to-date information tailored to support your transition to Australia, including a pre-departure checklist and even scholarship information.

Check it out at latrobe.edu.au/international/welcome

You can also visit our on-demand orientation program for more information on living in Australia: latrobe.edu.au/students/getting-started/orientation/on-demand

Once you've accepted your offer, we'll contact you about how to complete your pre-arrival online enrolment. If you have questions along the way, we're here to support you.

Find out more at latrobe.edu.au/int-enrol

Living in Australia webinar

Our comprehensive Living in Australia webinar offers you support and advice on everything you need to know before leaving your home to transition to Australia. It covers valuable information regarding accommodation, transport, food, working, health services and staying safe.

Entering Australia

Information regarding the requirements to enter Australia is found on the Department of Home Affairs website. It is your responsibility to read and follow the requirements of the Australian Government.

Checking in

When you're on campus for the first time, we invite you to our welcome zone at Ask La Trobe. This is the best way to meet our team face-to-face and get your questions answered, so you can start your studies at La Trobe.

Find out more at latrobe.edu.au/students/ask-us

Orientation

Orientation is full of important sessions and social activities, so you'll need to attend it at the start of semester. You'll make new friends, learn important information about campus life and set yourself up for your time here.

Learn more at latrobe.edu.au/int-orientation

Supporting you to graduation

Student Advising

Want to reach your full potential? La Trobe's Student Advising team is here to help guide your transition into university and enable you to develop a sense of connection and community at La Trobe. Things they can help you with include clarifying career goals, developing a sustainable educational plan, connecting with appropriate support and building resilience, motivation and self-efficacy.

Find out more at latrobe.edu.au/learning-and-teaching/student-success/student-advising

Personal support

Our Advising team can help you with almost any personal issue you encounter, whether it's social, financial, cultural or anything else. You can book a confidential one-on-one appointment with our supportive and professional staff.

Learn more at latrobe.edu.au/learning-and-teaching/student-success/student-advising

Career support

All La Trobe students have access to our leading Career Ready Advantage program. Graduate with experience, confidence and a career portfolio that's sure to impress.

Find out more at latrobe.edu.au/int-career

Overseas study programs

Make the world your campus. Study with one of our 130 overseas study partners to help you broaden your horizons and make global connections while you gain credit towards your La Trobe degree.

Learn more about programs and funding at latrobe.edu.au/int-overseas

Connect with other students

There are plenty of ways to connect with on-campus and off-campus communities while you're studying with us – whether you're in Australia or studying online from home. You'll build friendships, grow your professional networks, and meet people from around the world with our social programs and cultural events.

Find out more at latrobe.edu.au/int-social

Always available

We'll stay connected with you for the entire time you're at La Trobe. We even have a 24-hour student support hotline where we can help you with anything you may be concerned about.

Learn more at latrobe.edu.au/int-support-services

When you choose La Trobe, we're there for you every step of the way with advice, information and support.

Our International Student Services team will help you feel at home at La Trobe – whether you're in Australia or studying online – and support you to succeed in your studies.

Prepare for your career

Want to gain an exciting and fulfilling career once you've finished your degree?

At La Trobe, we design our courses with industry to make sure you build the skills your future employers need. We also partner with industry to offer you placement opportunities in your chosen field. And our Career Ready Advantage program means you'll graduate with experience, confidence and a career portfolio that's sure to impress.

Career Ready Advantage

You can get the skills employers are looking for with Career Ready Advantage: designed with industry partners such as PwC, one of the world's largest professional services firms; Optus, one of Australia's three biggest telecommunication firms; and the Commonwealth Bank, Australia's largest banking organisation.

Career Ready Advantage Award

With the Career Ready Advantage Award, you'll be rewarded as you develop industry-relevant skills during your degree and outside the classroom. As you study, you can work towards a Silver, Gold or Platinum award and have your achievements formally recognised. At the same time, you'll access opportunities to connect with your chosen industry and develop your leadership skills.

Develop the skills employers want

La Trobe's Career Ready Advantage expands on the technical skills you learn in your course. It helps you develop the qualities employers are looking for: passion, empathy, curiosity and resilience. You'll also:

- Enhance your communication and literacy skills to confidently engage, build relationships and work effectively with diverse groups of people.
- Build personal and professional skills to manage yourself and others in the workplace with integrity, adaptability and emotional intelligence.
- Develop critical thinking and research skills to interpret data and create innovative solutions for complex problems.

Build your Career Ready Advantage

To get started, download the MyLaTrobe app or visit latrobe.edu.au/int-career

Support from day one

As you prepare for your future career, we'll be there every step of the way with:

- Support finding work through our on-campus recruitment service, with hundreds of casual and graduate opportunities advertised every year.
- Industry placement opportunities with our wide network of partner organisations.
- Industry mentoring with our high-profile graduates and partners.
- Opportunities to connect with potential employers through networking events, showcases and industry panels.
- Free LinkedIn Learning during your degree and after you graduate, with more than 14 000 online courses to choose from.
- Lifetime career support with ongoing access to online resources, workshops and networking.

Industry experience

Industry-based learning

You'll increase your employability while gaining the industry experience we've embedded into our teaching. Depending on your course and your eligibility, you'll build first-hand industry experience through:

- Guest lectures from industry experts.
- Real-world case studies and professional simulation activities.
- Industry projects guided by our staff.
- Field trips and study tours, both in Australia and overseas¹.
- In-class activities preparing you for work, like portfolio development, interview practice and resume writing.

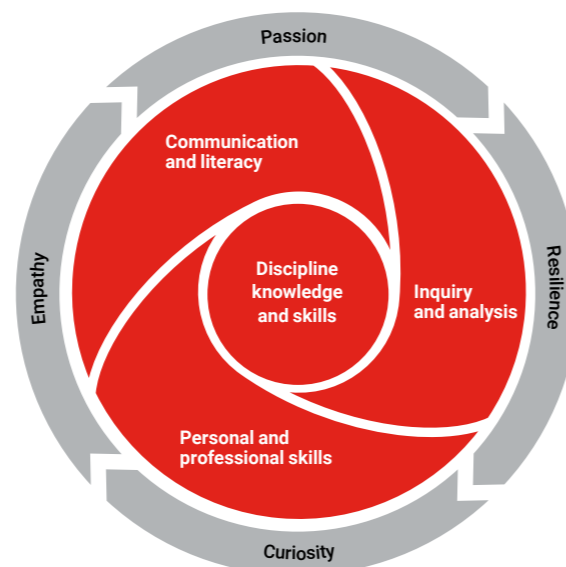

Industry placement opportunities

We offer a wide range of industry placement opportunities where you can build the skills and experience to set you apart from the crowd. Options for eligible students include placements, leadership programs, career workshops, overseas study¹ and more.

Best of all, many of our work-based learning opportunities are also available online through experiential learning platforms like Practera. This means you'll have access to a much wider range of experiences – whether they're on the other side of town or the other side of the world. Taking part in online placements also gives you the chance to develop the remote working skills that have become invaluable in the modern workforce.

Find out more at latrobe.edu.au/int-career



Academic and English language requirements

Before you can enrol in to your course, you'll need to meet our entry requirements.

Here's everything you need to know about the academic and English requirements you'll need to meet before you can study at La Trobe.

Academic requirements

We have minimum academic entry requirements for our courses, which are listed here. You can also find more information about our academic requirements at latrobe.edu.au/int-academic

Undergraduate

Whether you have your dream job in mind or are still figuring it out, an undergraduate degree from La Trobe will give you the knowledge, experience and connections you need to build your career. Undergraduate courses available at La Trobe include:

- Diploma programs
- Bachelor's degrees.

To enter our undergraduate programs, at a minimum you'll need to have completed Australian Year 12 (or an accepted international equivalent) with a certain grade. You may also need to meet subject prerequisites.

Postgraduate coursework

Already completed a Bachelor's degree (or international equivalent) or have significant professional experience in a relevant field? Take your next step by choosing a postgraduate degree that suits your career aspirations and your lifestyle needs. Postgraduate courses available at La Trobe include:

- Graduate Certificate programs
- Graduate Diploma programs
- Master's degrees by coursework.

To enter our postgraduate degree programs, at a minimum you'll need to have completed an Australian Bachelor's degree (or international equivalent) with certain grades. For some degrees, we may also consider prior learning that you've developed through relevant work experience or professional accreditation, if we deem it to be at least equivalent to the education you'd receive in a Bachelor's degree.

Some courses may have additional entry requirements. Please refer to specific course requirements at latrobe.edu.au/int-courses

Higher degrees by research

Do you have proven research capabilities? We offer three types of graduate research degrees, also known as higher degrees by research, depending on your goals and your educational and professional background. Higher degree research options available at La Trobe include:

- Masters degrees by research
- Professional Doctorates
- Doctors of Philosophy (PhDs).

Find out more at latrobe.edu.au/research/graduate-research/apply/degrees

English language requirements

We're proud to welcome students from all over the world to La Trobe. To help all our students succeed academically, we have English language requirements for entry into our courses.

We have minimum language requirements for undergraduate, postgraduate and graduate research study at La Trobe. However, some La Trobe courses need a higher level of English language proficiency than these minimum scores.

Our course pages list the required English levels and accepted test methods needed for entry. If you know the course you want to study, you can search for your course and check its specific entry requirements.

Find out more at latrobe.edu.au/international/study

Found your course's required English language entry score and it's higher than our minimum requirements? Check our website for all equivalent scores: latrobe.edu.au/int-english

Other proof of English proficiency

We may also consider other factors when assessing if you meet the language requirements for your course, such as whether you've studied or worked in an English-speaking country.

International student pathways

Found your ideal course, but don't quite meet the academic or English requirements?

Don't worry. If you're an international student, you may be eligible for a pathway program to get you into a La Trobe course.

Pathways

We offer pathway programs through our on-campus partner La Trobe College Australia (LTCA). You'll study at our Melbourne and Sydney campuses, so you'll be immersed in the university experience from day one. You'll be supported by expert teachers who understand the unique needs of international students and can help prepare you to progress into university studies. Enjoy access to free services including one-on-one tutoring and English improvement sessions.

With programs that range in length from 10-week blocks to 12 months, LTCA is helping thousands of international students like you gain access to La Trobe University.

Undergraduate pathways

Do you need help to meet the academic entry requirements for your preferred undergraduate course? LTCA offers Foundation Studies and Diploma programs to prepare you for undergraduate study.

These programs provide pathways to a broad range of undergraduate courses. The Foundation Studies programs are equivalent to an Australian secondary school qualification and prepare you to enter the first year of your course. The Diploma programs help you transition into the second year.

Explore your options at latrobcollegeaustralia.edu.au

Postgraduate pathways

Want to study a Master's degree but don't meet the academic and/or English requirements? Our Postgraduate Enabling Program (PEP) provides a pathway into a wide range of our Master's courses.

Find at more at latrobe.edu.au/courses/postgraduate-enabling-program

English tuition

Don't meet the language requirements of your preferred course? Study English on-campus in Sydney or Melbourne with LTCA, then progress directly to your pathway or La Trobe course. Find out more at latrobcollegeaustralia.edu.au/programs/english-further-studies

Articulation arrangements

If you want some extra certainty about your future, our articulation arrangements with partner institutions around the globe can help you guarantee your path to La Trobe.

Completing one of the approved articulation courses with a partner institution guarantees that when you enter an eligible La Trobe course, you'll receive credit for your previous studies (also known as 'advanced standing'). This can shorten the duration of your study and reduce the cost of your La Trobe study.

You may also be entitled to two awards when you graduate – one from us, and one from your home institution.

Certain pathways may have additional requirements or restrictions that affect admission into our degrees, or the credit you're awarded upon admission, or your progression within the degree.

Find out more at latrobe.edu.au/international/study/articulations

Minimum English language requirements

Programs	IELTS Academic ¹	TOEFL iBT	PTE Academic ²	C1 Advanced ³	C2 Proficiency ⁴
Undergraduate courses	Overall score of 6.0 with no band less than 6.0	Overall 64 with 13 in Reading, 12 in Listening, 18 in Speaking and 21 in Writing	Overall score of 50 with no communicative skill score less than 50	169 with no less than 169 in any component	176 with no less than 169 in any component
Postgraduate coursework and graduate research degrees	Overall score of 6.5 with no band less than 6.0	Overall 79 with 13 in Reading, 12 in Listening, 18 in Speaking and 21 in Writing	Overall score of 58 with no communicative skill score less than 50	176 with no less than 169 in any component	176 with no less than 169 in any component

1. IELTS General Training is not accepted for admission into our courses.
 2. PTE academic test taken before 1 Dec 2020.
 3. Formerly known as Cambridge English: Advanced and Certificate in Advanced English.
 4. Formerly known as Cambridge English: Proficiency and Certificate of Proficiency in English.

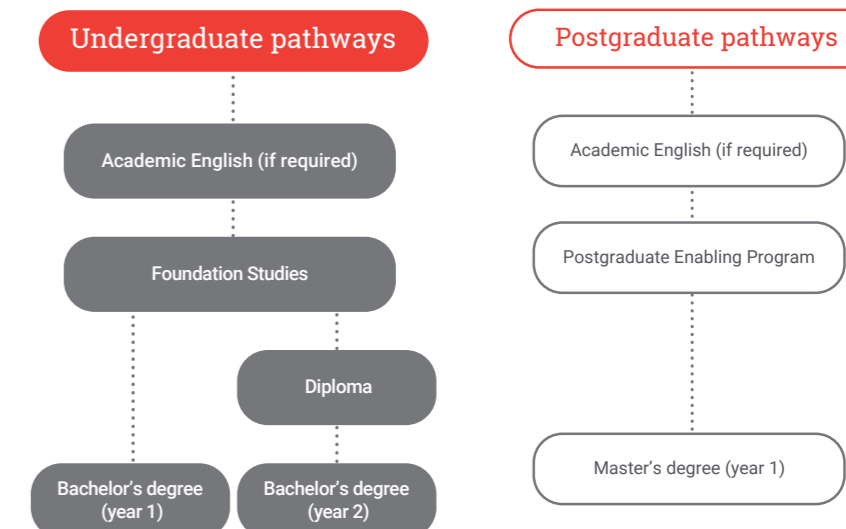

Undergraduate courses

Arts, social sciences and communications

Bachelor's and double degrees	CRICOS	📍	📅	🕒	💰
Bachelor of Archaeology	0100732	MEL	Sem 1, Sem 2	3 years	32 200
Bachelor of Arts	002080A	MEL	Sem 1, Sem 2	3 years	31 400
Bachelor of Arts/Bachelor of Health Sciences	025959E	MEL	Sem 1, Sem 2	4 years	36 000
Bachelor of Global Studies	106465H	MEL	Sem 1, Sem 2	3 years	32 800
Bachelor of Languages and Linguistics	0100735	MEL	Sem 1, Sem 2	3 years	32 200
Bachelor of Media and Communication	086278C	MEL	Sem 1, Sem 2	3 years	33 600
Bachelor of Planning (Honours)	107133J	BEN	Sem 1, Sem 2	4 years	31 600
Bachelor of Politics, Philosophy and Economics	071901G	MEL	Sem 1, Sem 2	3 years	33 000
Bachelor of Visual Arts	110457G	BEN	Sem 1, Sem 2	3 years	34 400

Diplomas and Associate Degrees	CRICOS	📍	📅	🕒	💰
Associate Degree in Urban and Regional Environments	107138D	BEN	Sem 1, Sem 2	2 years	31 600
Diploma in Urban and Regional Environments	107137E	BEN	Sem 1, Sem 2	1 year	31 600

Honours year	CRICOS	📍	📅	🕒	💰
Bachelor of Archaeology (Honours)	068376F	MEL	Sem 1, Sem 2	1 year	32 200
Bachelor of Arts (Honours)	063461E	MEL	Sem 1, Sem 2	1 year	31 400
Bachelor of Creative Arts (Honours)	068377E	MEL	Sem 1, Sem 2	1 year	34 400
Bachelor of International Relations (Honours)	068379C	MEL	Sem 1, Sem 2	1 year	32 800

Business and commerce

Bachelor's and double degrees	CRICOS	📍	📅	🕒	💰
Bachelor of Accounting	066343J	BEN ¹ , MEL, SYD	Sem 1, Sem 2, Term 6	3 years	36 200
Bachelor of Business	019479E / 083528C	BEN ¹ , MEL, SYD ²	Sem 1, Sem 2, Term 6	3 years ³	36 400
Bachelor of Business Analytics	0100037	MEL	Sem 1, Sem 2, Term 6	3 years	37 400
Bachelor of Commerce	084539C	MEL	Sem 1, Sem 2, Term 6	3 years	39 000
Bachelor of Commerce/Bachelor of Arts	084537E	MEL	Sem 1, Sem 2	4 years	39 000
Bachelor of Commerce/Bachelor of Biomedicine	096757E	MEL	Sem 1, Sem 2	4 years	39 000
Bachelor of Commerce/Bachelor of Computer Science	092917D	MEL	Sem 1, Sem 2	4 years	39 000
Bachelor of Commerce/Bachelor of Global Studies	106768D	MEL	Sem 1, Sem 2	4 years	39 000
Bachelor of Commerce/Bachelor of Health Sciences	093259C	MEL	Sem 1, Sem 2	4 years	39 000
Bachelor of Commerce/Bachelor of Psychological Science	099396A	MEL	Sem 1, Sem 2	4 years	39 600
Bachelor of Commerce/Bachelor of Science	085379F	MEL	Sem 1, Sem 2	4 years	39 000

1. Bendigo only has intakes in Semester 1 and Semester 2.

2. Sydney CRICOS code: 083528C.

3. Students who come in with 1-year advanced standing will have a CoE against the Bachelor of Business (104 weeks) program which has a different - CRICOS Course code of 083527D.

4. Bendigo only has Semester 1 intake.

📍 Campus location and course code 📅 Course intake 🕒 Course duration 💰 Indicative annual tuition fee in AU\$ **CRICOS** Course CRICOS registration code
 MEL Melbourne BEN Bendigo A-W Albury-Wodonga MIL Mildura SHP Shepparton SYD Sydney CTY City EPP Epping (Melbourne Polytechnic)

Please note:

Some courses may have additional costs and intake dates could change throughout the year and may vary between campuses. In some instances, courses will have additional admission requirements - we always keep the latest information on our course pages online, so check course listings on our website.

Criminology

Bachelor's and double degrees	CRICOS	📍	📅	🕒	💰
Bachelor of Criminology	089314B	MEL	Sem 1, Sem 2	3 years	36 600
Bachelor of Criminology/Bachelor of Psychological Science	096350F	BEN ⁴ , MEL	Sem 1, Sem 2	4 years	39 600

Honours year	CRICOS	📍	📅	🕒	💰
Bachelor of Criminology (Honours)	0100130	MEL	Sem 1, Sem 2	1 year	36 600

Education and teaching

Bachelor's and double degrees	CRICOS	📍	📅	🕒	💰
Bachelor of Education	110999K	MIL, A-W, MEL, BEN, SHP	Sem 1, Sem 2	4 years	34 000
Bachelor of Outdoor and Sustainability Education	106466G	BEN	Sem 1	3 years	33 400

Diplomas and Associate Degrees	CRICOS	📍	📅	🕒	💰
Associate Degree of Teacher Education	106755J	MIL, A-W, MEL, BEN, SHP	Sem 1, Sem 2	2 Years	34 000

Engineering

Bachelor's and double degrees	CRICOS	📍	📅	🕒	💰
Bachelor of Civil Engineering (Honours)	078469G	BEN, MEL	Sem 1, Sem 2	4 years	36 400
Bachelor of Engineering Honours (Industrial)	095713C	BEN, MEL	Sem 1, Sem 2	4 years	36 400

Diplomas and Associate Degrees	CRICOS	📍	📅	🕒	💰
Associate Degree in Engineering Technology	106835J	MEL, BEN	Sem 1, Sem 2	2 years	36 400

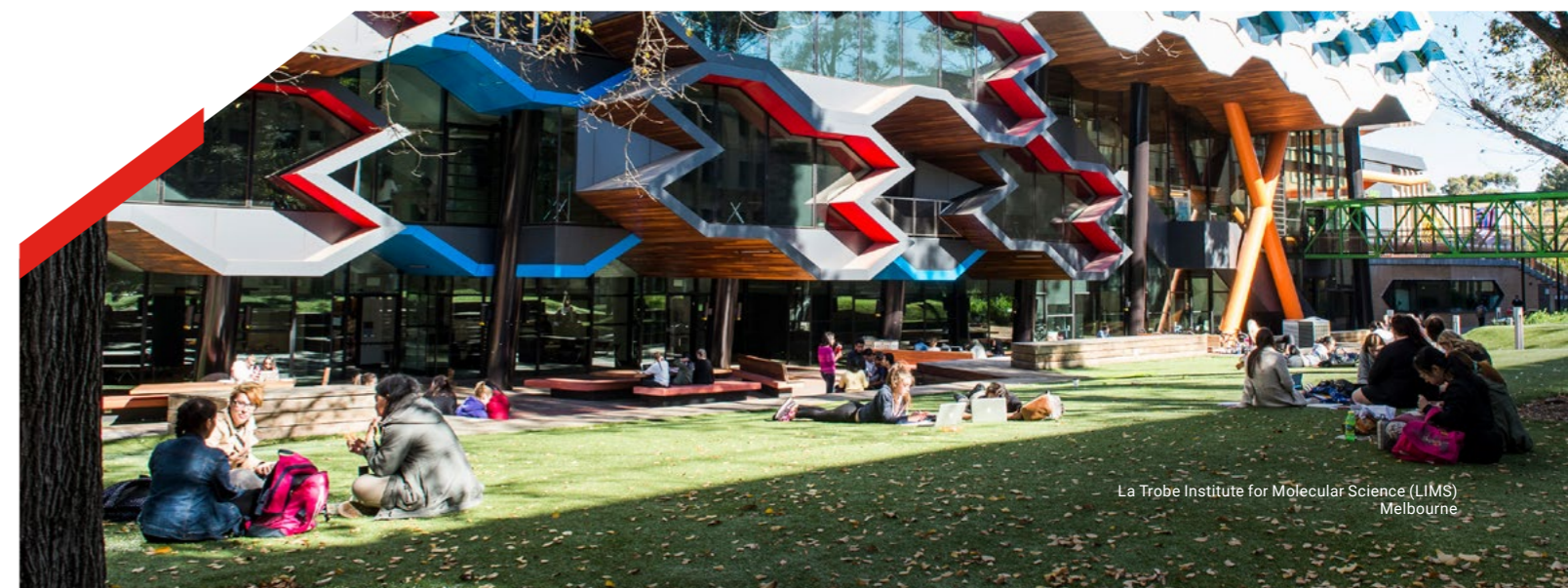

Undergraduate courses

Health

Bachelor's and double degrees	CRICOS	📍	📅	🕒	💰
Bachelor of Biomedical Science	062549E	A-W, BEN	Sem 1, Sem 2	3 years	38 600
Bachelor of Dental Science (Honours)	0100799	BEN	Sem 1	5 years	74 600
Bachelor of Exercise Science	079549K	BEN	Sem 1, Sem 2	3 years	38 000
Bachelor of Health Information Management	106398C	MEL	Sem 1	3 years	36 000
Bachelor of Health Sciences	062598G	BEN, MEL	Sem 1	3 years	36 000
Bachelor of Nursing (Enrolled Nurse)	0100267	A-W, BEN, MEL, MIL, SHP	Sem 1 ¹	2 years	39 600
Bachelor of Nursing (Graduate Entry)	070855F	A-W, BEN, MEL, MIL, SHP	Sem 1 ¹	2 years	39 600
Bachelor of Nursing (Pre-registration)	020935J	A-W, BEN, MEL ² , MIL, SHP	Sem 1, Sem 2	3 years	39 600
Bachelor of Nursing/Bachelor of Psychological Science	098012G	MEL	Sem 1	4 years	39 600
Bachelor of Nutrition Science	102576M	MEL	Sem 1	3 years	37 400
Bachelor of Occupational Therapy (Honours)	0101261	MEL, BEN	Sem 1	4 years	39 000
Bachelor of Oral Health Science	089313C	BEN	Sem 1	3 years ³	43 000
Bachelor of Orthoptics (Honours)	0100796	MEL	Sem 1	4 years	42 800
Bachelor of Paramedic Practice with Honours	095691D	BEN	Sem 1	4 years	37 400
Bachelor of Pharmacy (Honours)	069561G	BEN	Sem 1	4 years	45 400
Bachelor of Physiotherapy (Honours)	0101262	MEL, BEN	Sem 1	4 years	50 200
Bachelor of Podiatry (Honours)	0100797	MEL	Sem 1	4 years	40 600
Bachelor of Prosthetics and Orthotics (Honours)	0100798	MEL	Sem 1	4 years	37 000
Bachelor of Psychological Science	002915G	A-W, BEN, MEL	Sem 1, Sem 2	3 years	39 600
Bachelor of Psychological Science with Honours	069379F	A-W, BEN, MEL	Sem 1	1 year	41 200
Bachelor of Social Work (Honours)	0101263	A-W, BEN, MEL ⁴ , MIL, SHP	Sem 1, Sem 2	4 years	33 500
Bachelor of Speech Pathology (Honours)	0101264	BEN, MEL	Sem 1	4 years	47 800
Bachelor of Sport and Exercise Science	095558J	MEL	Sem 1	3 years	37 400
Bachelor of Sport Coaching and Development	098511M	MEL	Sem 1	3 years	37 400

Honours year	CRICOS	📍	📅	🕒	💰
Bachelor of Health Sciences (Honours)	062906M	MEL, BEN	Sem 1	1 year	36 000
Bachelor of Sport and Exercise Science (Honours)	095557K	MEL	Sem 1	1 year	37 400

Information technology

Bachelor's and double degrees	CRICOS	📍	📅	🕒	💰
Bachelor of Computer Science	022037E	MEL	Sem 1, Sem 2, Term 6	3 years	36 200
Bachelor of Cybersecurity	096351E	MEL	Sem 1, Sem 2, Term 6	3 years	37 200
Bachelor of Cybersecurity/Bachelor of Commerce	0100860	MEL	Sem 1	4 years	39 000
Bachelor of Cybersecurity/Bachelor of Criminology	0100861	MEL	Sem 1	4 years	37 200
Bachelor of Cybersecurity/Bachelor of Psychological Science	096858M	MEL	Sem 1	4 years	39 600
Bachelor of Information Technology	049940G	BEN, MEL, SYD	Sem 1, Sem 2, Term 6	3 years	36 200

📍 Campus location and course code 📅 Course intake 🕒 Course duration 💰 Indicative annual tuition fee in AU\$ **CRICOS** Course CRICOS registration code
 MEL Melbourne BEN Bendigo A-W Albury-Wodonga MIL Mildura SHP Shepparton SYD Sydney CTY City EPP Epping (Melbourne Polytechnic)

Please note:

Some courses may have additional costs and intake dates could change throughout the year and may vary between campuses. In some instances, courses will have additional admission requirements - we always keep the latest information on our course pages online, so check course listings on our website.

Law

Bachelor's and double degrees	CRICOS	📍	📅	🕒	💰
Bachelor of Laws (Honours)	106400C	BEN ⁵ , MEL	Sem 1, Sem 2	4 years	39 800
Bachelor of Laws (Honours) (Graduate Entry)	106401B	BEN ⁵ , MEL	Sem 1, Sem 2	3 years	39 800
Bachelor of Laws (Honours)/Bachelor of Arts	107090D	BEN ⁵ , MEL	Sem 1, Sem 2	5 years	39 800
Bachelor of Laws (Honours)/Bachelor of Biomedicine	106402A	MEL	Sem 1, Sem 2	5 years	39 800
Bachelor of Laws (Honours)/Bachelor of Commerce	106773G	MEL	Sem 1, Sem 2	5 years	39 800
Bachelor of Laws (Honours)/Bachelor of Criminology	106404K	BEN ⁵ , MEL	Sem 1, Sem 2	5 years	39 800
Bachelor of Laws (Honours)/Bachelor of Global Studies	106772H	MEL	Sem 1, Sem 2	5 years	39 800
Bachelor of Laws (Honours)/Bachelor of Media and Communication	106774F	MEL	Sem 1, Sem 2	5 years	39 800
Bachelor of Laws (Honours)/Bachelor of Politics, Philosophy and Economics	107091C	MEL	Sem 1, Sem 2	5 years	39 800
Bachelor of Laws (Honours)/Bachelor of Psychological Science	106403M	BEN ⁵ , MEL	Sem 1, Sem 2	5 years	39 800
Bachelor of Laws (Honours)/Bachelor of Science	107092B	BEN ⁵ , MEL	Sem 1, Sem 2	5 years	39 800

Science

Bachelor's and double degrees	CRICOS	📍	📅	🕒	💰
Bachelor of Agriculture	104803M	A-W, MEL	Sem 1	3 years	39 800
Bachelor of Animal and Veterinary Biosciences	060348G	A-W, MEL	Sem 1	3 years	39 000
Bachelor of Arts/Bachelor of Science	106838F	MEL	Sem 1, Sem 2	4 years	37 000
Bachelor of Biological Sciences	006171K	A-W, MEL	Sem 1, Sem 2	3 years	37 800
Bachelor of Biomedicine	095556M	MEL	Sem 1	3 years	38 600
Bachelor of Science	022039C	BEN, MEL	Sem 1, Sem 2	3 years	37 000
Bachelor of Veterinary Nursing	096716C	EPP	Sem 1	3 years	37 000
Bachelor of Wildlife and Conservation Biology	103743D	MEL	Sem 1	3 years	37 000

Honours year	CRICOS	📍	📅	🕒	💰
Bachelor of Agricultural Sciences with Honours	069549D	MEL	Sem 1, Sem 2	1 year	39 800
Bachelor of Animal and Veterinary Biosciences with Honours	069550M	A-W ⁷ , MEL	Sem 1 ⁶	1 year	39 000
Bachelor of Biological Sciences with Honours	067836B	A-W, MEL	Sem 1 ⁶ , Sem 2	1 year	37 800
Bachelor of Biomedicine (Honours)	095555A	MEL	Sem 1 ⁶ , Sem 2	1 year	38 600
Bachelor of Science (Honours)	065395E	BEN, MEL	Sem 1, Sem 2	1 year	37 000

1. Semester 1 early commencement on 30 January 2023.

2. Only Melbourne Campus has a Semester 2 intake in 2023. It is an accelerated program with early commencement on 26 June 2023.

3. This course is 2.5 years full-time as accelerated (equivalent to 3 years of full-time study). Some students may take longer.

4. Melbourne Campus only has a Semester 1 intake.

5. Bendigo Campus only has Semester 1 intake.

6. Melbourne Campus only: Semester 1 early commencement on 30 January 2023

7. Albury-Wodonga Campus only has Semester 1 intake.

Postgraduate courses

Arts, social sciences and communications

Graduate Certificates	CRICOS	📍	📅	🕒	💰
Graduate Certificate in Planning	107135G	BEN	Sem 1, Sem 2	6 months	17 100
Graduate Certificate of Archaeology	091422B	MEL	Sem 1	6 months	18 200
Graduate Diplomas	CRICOS	📍	📅	🕒	💰
Graduate Diploma in Planning	107136F	BEN	Sem 1, Sem 2	1 year	34 200
Graduate Diploma of Archaeology	107139C	MEL	Sem 1, Sem 2	1 year	36 400
Master's degrees	CRICOS	📍	📅	🕒	💰
Master of Archaeology	107140K	MEL	Sem 1, Sem 2	2 years	36 400
Master of International Development	079183B	MEL	Sem 1, Sem 2	2 years	35 800
Master of International Relations	079184A	MEL	Sem 1, Sem 2	2 years	35 800
Master of Planning	107134H	BEN	Sem 1, Sem 2	2 years	34 200

Business and commerce

Postgraduate Enabling	CRICOS	📍	📅	🕒	💰
Postgraduate Enabling Program	088963K	SYD, MEL (via LTCA)	Sem 1, Sem 2	6 months	14 100
Graduate Certificates	CRICOS	📍	📅	🕒	💰
Graduate Certificate in Business	079546B	MEL, SYD	Sem 1, Sem 2, Term 6	6 months	20 200
Graduate Certificate in Logistics and Supply Chain Management	106771J	MEL	Sem 1, Sem 2	6 months	20 700
Graduate Certificate in Professional Accounting	107148B	BEN, MEL, SYD	Sem 1, Sem 2	6 months	19 900
Graduate Diplomas	CRICOS	📍	📅	🕒	💰
Graduate Diploma in Business	079545C	MEL	Sem 1, Sem 2	1 year	40 400
Graduate Diploma in Business Administration	075422B	CTY	Sem 1, Sem 2	1 year	42 800
Graduate Diploma in Business Analytics	087776K	CTY	Sem 1, Sem 2, Term 6	1 year	36 400
Graduate Diploma in Engineering Management	108004K	MEL	Sem 1, Sem 2	1 year	39 600
Graduate Diploma in International Business	107086M	MEL	Sem 1, Sem 2, Term 6	1 year	39 800
Graduate Diploma in Logistics and Supply Chain Management	106770K	MEL	Sem 1, Sem 2, Term 6	1 year	41 400
Graduate Diploma in Marketing	107087K	MEL	Sem 1, Sem 2, Term 6	1 year	39 800
Master's degrees	CRICOS	📍	📅	🕒	💰
Master of Business Administration	075421C	A-W, BEN, CTY, MIL, SHP	Sem 1, Sem 2	1.5 years	42 800
Master of Business Administration (Advanced)	080774B	CTY	Sem 1, Sem 2	2 years	42 800
Master of Business Analytics	087774A	CTY	Sem 1, Sem 2, Term 6	2 years	36 400
Master of Business Information Systems	107439B	MEL	Sem 1, Sem 2, Term 6	2 years	36 400
Master of Engineering Management	080775A	MEL	Sem 1, Sem 2, Term 6	2 years	39 600
Master of Extended Professional Accounting	106759E	BEN ¹ , MEL, SYD	Sem 1, Sem 2, Term 6	2 years	39 800
Master of Financial Analysis	079189G	MEL	Sem 1, Sem 2, Term 6	2 years	39 600
Master of International Business	078690B	MEL, SYD	Sem 1, Sem 2, Term 6	2 years	39 800
Master of Logistics and Supply Chain Management	106769C	MEL	Sem 1, Sem 2, Term 6	2 years	41 400
Master of Management	077460B	BEN ¹ , MEL, SYD	Sem 1, Sem 2, Term 6	2 years	40 400
Master of Marketing	093383K	MEL	Sem 1, Sem 2, Term 6	2 years	39 800
Master of Professional Accounting	106758F	BEN ¹ , MEL, SYD	Sem 1, Sem 2, Term 6	1.5 years	39 800

📍 Campus location and course code 📅 Course intake 🕒 Course duration 💰 Indicative annual tuition fee in AU\$ **CRICOS** Course CRICOS registration code
 MEL Melbourne BEN Bendigo A-W Albury-Wodonga MIL Mildura SHP Shepparton SYD Sydney CTY City EPP Epping (Melbourne Polytechnic)

Please note:

Some courses may have additional costs and intake dates could change throughout the year and may vary between campuses. In some instances, courses will have additional admission requirements - we always keep the latest information on our course pages online, so check course listings on our website.

Education and teaching

Graduate Diplomas	CRICOS	📍	📅	🕒	💰
Graduate Diploma in Education	106756H	MEL	Sem 1, Sem 2	1 year	33 400
Master's degrees	CRICOS	📍	📅	🕒	💰
Master of Education	011412M	MEL	Sem 1, Sem 2	2 years	33 400

Engineering

Graduate Diplomas	CRICOS	📍	📅	🕒	💰
Graduate Certificate in Professional Engineering	104736F	MEL	Sem 1, Sem 2	6 months	19 300
Master's degrees	CRICOS	📍	📅	🕒	💰
Master of Construction and Engineering Management	0101683	BEN, MEL	Sem 1, Sem 2	2 years	38 600
Master of Engineering	104735G	BEN ¹ , MEL	Sem 1, Sem 2, Term 6	2 years	38 600

Health

Graduate Certificates	CRICOS	📍	📅	🕒	💰
Graduate Certificate in Digital Health	102426C	MEL	Term 2, Term 3, Term 4, Term 5, Term 6 ²	6 months	18 300
Master's degrees	CRICOS	📍	📅	🕒	💰
Master of Art Therapy	077479B	MEL	Sem 1	2 years	39 000
Master of Clinical Audiology	080780D	MEL	Sem 1	2 years	44 200
Master of Clinical Psychology	006277M	MEL	Sem 1 ³	2 years	39 000
Master of Digital Health	0101684	MEL	Term 2, Term 3, Term 4, Term 5, Term 6 ²	2 years	36 600
Master of Health Administration	030972K	CTY	Term 2, Term 3, Term 4, Term 5, Term 6 ²	2 years	39 000
Master of Health Information Management	062804F	MEL	Sem 1	2 years	43 600
Master of Nursing	107440J	MEL	Sem 1, Sem 2	2 years	33 600
Master of Occupational Therapy Practice	062795B	MEL	Sem 1 ⁴	2 years	42 200
Master of Physiotherapy Practice	062798K	BEN, MEL	Sem 1 ⁵	2 years	51 400
Master of Public Health	019986G	CTY	Term 2, Term 3, Term 4, Term 5, Term 6 ²	2 years	38 800
Master of Public Health and Master of Health Administration	019986G/ 069741D	CTY	Term 2, Term 3, Term 4, Term 5, Term 6 ²	2.5 years	39 000
Master of Rehabilitation Counselling and Mental Health	106839E	CTY	Sem 1, Sem 2	2 years	38 000
Master of Speech Pathology	073116F	MEL	Sem 1 ³	2 years	46 200
Master of Sport Analytics	103840C	MEL	Sem 1	2 years	38 200

1. Bendigo Campus only has intakes in Semester 1 and Semester 2.
 2. Term 1 (January 2023), Term 2 (February 2023), Term 3 (April 2023),
 Term 4 (July 2023), Term 5 (September 2023), Term 6 (November 2023).

3. Early start date: 30 January 2023.
 4. Early start date: 23 January 2023.
 5. Early start date: 16 January 2023.

Postgraduate courses

Information technology

Graduate Certificates	CRICOS	📍	📅	🕒	💰
Graduate Certificate in Information Technology Fundamentals	102578J	MEL	Sem 1, Sem 2	6 months	18 900
Master's degrees	CRICOS	📍	📅	🕒	💰
Master of Artificial Intelligence	0100864	MEL	Sem 1, Sem 2, Term 6	2 years	37 800
Master of Cybersecurity	104801B	MEL	Sem 1, Sem 2, Term 6	2 years	38 200
Master of Data Science	092396B	MEL	Sem 1, Sem 2, Term 6	2 years	37 800
Master of Information and Communication Technology	061684F	BEN ¹ , MEL	Sem 1, Sem 2, Term 6	2 years	28 650
Master of Information Technology	037928B	BEN ¹ , MEL	Sem 1, Sem 2, Term 6	2 years	38 200
Master of Internet of Things	0100862	BEN	Sem 1, Sem 2	2 years	38 400

Law

Doctoral degrees	CRICOS	📍	📅	🕒	💰
Juris Doctor	084540K	CTY	Sem 1	3 years	42 000

Science

Master's degrees	CRICOS	📍	📅	🕒	💰
Master of Biotechnology and Bioinformatics	049585K	MEL	Sem 1, Sem 2	2 years	39 000
Master of Biotechnology Management	091417K	MEL	Sem 1, Sem 2	2 years	39 000
Master of Chemical Sciences	062473J	MEL	Sem 1, Sem 2	2 years	39 600

1. Melbourne Campus only: Semester 1 early commencement on 30 January 2023

📍 Campus location and course code 📅 Course intake 🕒 Course duration 💰 Indicative annual tuition fee in AU\$ 📄 CRICOS Course CRICOS registration code
 MEL Melbourne BEN Bendigo A-W Albury-Wodonga MIL Mildura SHP Shepparton SYD Sydney CTY City EPP Epping (Melbourne Polytechnic)

Please note:

Some courses may have additional costs and intake dates could change throughout the year and may vary between campuses. In some instances, courses will have additional admission requirements - we always keep the latest information on our course pages online, so check course listings on our website.



La Trobe Rural Health School, HHS2 building
Bendigo

Research at La Trobe



“ La Trobe has really developed me. I have wonderful supervisors and meet so many people from other cultures. You get to work with these amazing people and broaden your horizons. ”

Justin See
Philippines

PhD (Community Planning)
2020 International Student of the Year
– Premier’s Award and Regional Award

When you research at La Trobe, you’re choosing to be at the centre of a globally renowned research community that’s making a real impact, right here and now.

You’re also choosing:

- World-class facilities and partnerships connecting health, science and technology education with industries.
- Dedicated support network preparing researchers for successful careers.
- To be part of a group of leading Australian and international researchers who are working together with their community.

We’re proud to be known for excellence in every aspect of our research – we’re top-rated nationally and rated well-above world standard in 23 fields of research.¹ We develop creative and innovative responses to the fundamental challenges facing our world. When you join us, you will too.

Our degrees

We offer Doctor of Philosophy (PhD), Professional Doctorate and Masters by research programs depending on your goals and your educational and professional background.

Find out which degree is right for you at latrobe.edu.au/int-research-degrees

There’s more than one way to start a graduate research degree at La Trobe. You can consider one of our graduate degree pathways where you may be able to transfer to a Master’s by research from an Honours degree or Master’s by coursework, subject to meet the requirements.

Find out more at latrobe.edu.au/study/apply/research/transfer

Research themes

Our research is focused on five priority areas linked to the United Nation’s Sustainable Development Goals. Our expertise across disciplines, combined with our commitment to digital innovation, positions us to excel in these areas:

- healthy people, families and communities
- understanding and preventing disease
- sustainable food and agriculture
- resilient environments and communities
- social change and equity.

Learn more at latrobe.edu.au/int-research-themes

How we’ll help you

Research infrastructure

As a graduate research candidate, you’ll be able to access purpose-built and custom-designed research facilities. We’ve invested in infrastructure to help your research make an impact, from physical facilities like the La Trobe Institute for Molecular Science to our research platforms that maximise our strengths.

Find out more at latrobe.edu.au/int-research-facilities

Scholarships

We know what it’s like when you’re focused on your research – you don’t want anything to distract you. Our supportive scholarships for international students can help you cover tuition fees, manage your living expenses and more.

Learn more at latrobe.edu.au/int-research-scholarship

Research support

We have a dedicated Research Education and Education (RED) team that supports graduate researchers in:

- quality research practices
- strategies to achieve
- publication and source funding
- insight into career paths and industry sectors
- excellent research communication skills.

Find out more at latrobe.edu.au/int-red

Industry and community engagement

We know that graduates don’t always remain in academia. That’s why we’ll support you to develop your skills and build contacts outside the university sector. The people you meet at La Trobe will help you build a rewarding career, no matter where life takes you.

If you want to grow your networks while you research, we can assist you to engage with industry partners. We also offer La Trobe PhD with an industry focus, which embeds you in an organisation where you’ll use your research to solve problems and build your professional networks.

You’ll learn from Australian industry leaders and build a track record of delivering results. And when you’re finished, you’ll be amazed at the opportunities that come your way.

There’s more information at latrobe.edu.au/int-industry-community

How to get started

Ready to change the world? Find out how to research at La Trobe online at latrobe.edu.au/int-apply-research

Graduate research school

Master's degrees	CRICOS	📍	📅	🕒	\$
Master of Applied Science	074418F	A-W, BEN, MEL, CTY	Research Period 1, Research Period 2	2 years	44 200
Master of Arts	002093G	A-W, BEN, MEL, SHP	Research Period 1, Research Period 2	2 years	34 600
Master of Business	055085B	BEN, MEL	Research Period 1, Research Period 2	2 years	40 600
Master of Commerce	055086A	MEL	Research Period 1, Research Period 2	2 years	40 600
Master of Education	017544F	BEN, MEL	Research Period 1, Research Period 2	2 years	36 400
Master of Engineering	055088K	BEN, MEL	Research Period 1, Research Period 2	2 years	38 600
Master of Laws	055091D	MEL	Research Period 1, Research Period 2	2 years	39 000
Master of Philosophy	0100700/ 0100701	A-W, BEN, MEL, MIL, SHP	Research Period 1, Research Period 2	2 years	42 000 (high)/ 36 200 (low)
Master of Psychological Science	071896M	MEL	Research Period 1, Research Period 2	2 years	39 600
Master of Science	071897K	A-W, BEN, MEL, MIL, SHP	Research Period 1, Research Period 2	2 years	39 800
Master of Social Work	055101G	A-W, BEN, MEL, MIL	Research Period 1, Research Period 2	2 years	39 200
Master of Visual Arts	055102F	MIL, BEN	Research Period 1, Research Period 2	2 years	32 800

Doctoral degrees	CRICOS	📍	📅	🕒	\$
Doctor of Clinical Science	054041M	MEL	Research Period 1, Research Period 2	4 years	43 800
Doctor of Midwifery	0101141	A-W, BEN, MEL, MIL, SHP	Research Period 1, Research Period 2	4 years	41 200
Doctor of Nursing	024379M	A-W, BEN, MEL, MIL, SHP	Research Period 1, Research Period 2	4 years	41 200
Doctor of Philosophy	0100698/ 0100699	A-W, BEN, MEL, MIL, SHP	Research Period 1, Research Period 2	4 years	42 000 (high)/ 36 200 (low)
Doctor of Public Health	029304A	MEL	Research Period 1, Research Period 2	3 years	45 000
Doctor of Social Work	029305M	A-W, MEL	Research Period 1, Research Period 2	4 years	41 000

📍 Campus location and course code 📅 Course intake 🕒 Course duration 💰 Indicative annual tuition fee in AU\$ CRICOS Course CRICOS registration code
 MEL Melbourne BEN Bendigo A-W Albury-Wodonga MIL Mildura SHP Shepparton SYD Sydney CTY City EPP Epping (Melbourne Polytechnic)

Please note:

Some courses may have additional costs and intake dates could change throughout the year and may vary between campuses. In some instances, courses will have additional admission requirements - we always keep the latest information on our course pages online, so check course listings on our website.



How to apply

We can't wait to welcome you to La Trobe.

When you're ready to apply, we're here to help you with every part of the process – from helping you find the right course to preparing you for day one.

Find an agent

Want some extra support? Our authorised agents can help you with advice and information on the application process.

Find an authorised La Trobe University agent at latrobe.edu.au/int-agents



1. Choose your course

Find a course in this guide, then head online to find out all the details. Want to speak to someone about which course is right for you? We're here to help. Get in touch at latrobe.edu.au/int-contact



2. Check the entry requirements

Make sure you understand your course's entry requirements, including academic and English language requirements.

This guide lists indicative requirements for our courses. If you know the course you want to study, check its full entry requirements online at latrobe.edu.au/int-courses



3. Check your pathway options

Need support to meet your course's entry requirements?

We offer English language and pathway programs through our on-campus provider La Trobe College Australia: latrobe.edu.au/int-pathways



4. Get your documents ready

You'll need to scan and upload your documents to the International Online Application System. The documents required include:

- copies of your academic qualifications in your language and in a certified English translation – you'll need to submit your originals or certified copies of academic qualifications when you accept your offer.
- evidence of your English language proficiency
- any other information specified in the entry requirements for your course
- your course syllabus, if you're applying for advanced standing (credit)
- copy of passport
- current visa (if applicable)
- any additional forms required.

If you need help completing your application and would like to be in touch with one of our team members, please do not hesitate to contact us via email at LTUGlobal@latrobe.edu.au



5. Submit your application

We accept applications throughout the year. Our International Online Application System can be accessed at student-latrobe.studylink.com

La Trobe University requires students from certain regions to apply via an authorized agent. If you are unsure whether you will need to apply via an agent or not, please check with us via email at LTUGlobal@latrobe.edu.au

If you need any help completing your online application as direct student, or have any questions about the process, we're always here to help. Email us at LTUGlobal@latrobe.edu.au



6. Accept your offer

Once we've assessed your eligibility and if you're successful, we'll provide you with a letter of offer and offer acceptance form.

We'll also provide a guide on the next steps to accept your place in your course. Learn more at latrobe.edu.au/int-accept



7. Prepare for study at La Trobe

Our International Student Services team will help you prepare for study, and when it's time to join us on campus, they'll help you get ready for life in Australia.

Find out how at latrobe.edu.au/int-prepare

Key terms

There's a lot to learn at university – including how to talk about it.

Here are the meanings of some of the key words and phrases we use in this guide.

Advanced standing

If you've completed relevant, formally recognised studies at another uni or TAFE, including a Diploma or Associate Degree, or have suitable work experience, you may get advanced standing (also known as 'credit') for some or all of your studies when you enrol at uni. This means you may finish your degree faster.

Australian Tertiary Admissions Rank (ATAR)

If you're completing Year 12 in Australia, VTAC or UAC gives you an ATAR (a number between 0.00 and 99.95) to rank your Year 12 results against other students' results.

Entry requirements

Each course has different requirements you need to meet to be granted entry. These requirements include language proficiency, academic and professional experience. To understand different entry and academic requirements, please visit latrobe.edu.au/international/requirements/scores

Honours

Honours studies are advanced studies attached to undergraduate degrees that give you a higher qualification than a three-year degree. Many people do Honours so they can continue to postgraduate studies.

Depending on your course, this may involve an additional year of study, although some courses have it built in.

ELICOS

ELICOS is an acronym which stands for English Language Intensive Courses for Overseas Students. These courses are designed for students who require English language training before they commence tertiary study in Australia and can be undertaken at La Trobe University's on-campus partner, La Trobe College Australia (LTCA).

Industry placements

Industry placements integrate educational theory and workplace experience, preparing you to be work ready, world ready and future ready.

Major

A major is a way to specialise in your undergraduate course. It's made up of a sequence of related subjects spread over the duration of an undergraduate course. You'll usually undertake at least one subject from your major each semester, and you must pass each subject to move on to the next one in the sequence.

Specialisation

A specialisation is a way to specialise in your postgraduate course. It's made up of a sequence of related subjects spread over the duration of a postgraduate coursework course. The amount, structure and duration of subjects you need to undertake to secure a specialisation differs depending on the course.

OSHC

OSHC is an acronym which stands for Overseas Student Health Cover. You and your dependants must have OSHC as a condition of your student visa, unless you are one of the exceptions described below.

If you're in Australia on a visa other than a student visa, you aren't eligible for OSHC and need to arrange your own health insurance.

You don't need to get OSHC if you are:

- a Norwegian student covered by the Norwegian National Insurance Scheme
- a Swedish student covered by CSN International or Kammarkollegiet
- a Belgian student covered under the Reciprocal Health Care Agreement with Australia.

Pathways

Pathways let you enter your chosen course through another qualification. For example, the Diploma of Arts is one pathway to a Bachelor of Arts. Going from Year 12 to TAFE and then uni is another. You can also start a La Trobe degree with a lower entry requirement and apply for a transfer to your preferred degree.

Read more at latrobe.edu.au/study/apply/pathways/international

Tuition fee

When you study at La Trobe, your tuition fees are the monetary amount you need to pay for your course. This does not include living costs, books, stationary, transportation, visa or any other costs associated with studying abroad.

Fees are based on a standard annual credit point load of 120 credit points per year unless it's noted otherwise. If you change your study load your course fees will also change.

VET

VET is an acronym which stands for Vocational Education and Training.



LA TROBE
UNIVERSITY

AUSTRALIA

Want to know more? Get in touch



Phone enquiries
(+61 3) 6145 0033



Online chat
latrobe.edu.au/chat



Ask us a question
latrobe.edu.au/international/contact/form

Stay connected



Facebook
La Trobe University



LinkedIn
La Trobe University



Instagram
[@latrobeuni](https://www.instagram.com/latrobeuni)



Twitter
[@latrobe](https://twitter.com/latrobe)



WeChat
ID: LaTrobeUni_AU



Weibo
澳大利亚乐卓博大学官方微博
[@latrobeuniaux](https://www.weibo.com/latrobeuniaux)



Disclaimer: The information contained in this publication is indicative only. While every effort is made to provide full and accurate information at the time of publication, the University does not warrant the currency, accuracy or completeness of the contents. The University reserves the right to make changes without notice, at any time in its absolute discretion, including but not limited to varying admission or assessment requirements, or varying or discontinuing any course or subject. To the extent permitted by law, the University does not accept responsibility for any loss or damage occasioned by use of any of the information contained in this publication. For course information updates, please visit: latrobe.edu.au/int-courses

La Trobe University is a registered provider under the Commonwealth Register of Institutions and Courses for Overseas Students (CRICOS). CRICOS Provider 00115M. Published by La Trobe University, October 2022.

latrobe.edu.au/international